

# 160 Gauge Dimensions

Dimensions are in inches

**PROPRIETARY AND CONFIDENTIAL**  
 THE INFORMATION CONTAINED IN THIS DRAWING IS THE SOLE PROPERTY OF LASERLINC, INC. ANY REPRODUCTION IN PART OR AS A WHOLE WITHOUT THE WRITTEN PERMISSION OF LASERLINC, INC IS PROHIBITED.

		UNLESS OTHERWISE SPECIFIED:		NAME	DATE	LaserLinc, Inc.	
		DIMENSIONS ARE IN INCHES TOLERANCES: FRACTIONAL ± ANGULAR: MACH ± BEND ± TWO PLACE DECIMAL ±0.010 THREE PLACE DECIMAL ±0.005		DRAWN	ASM	10/24/06	TITLE: 160 Assembly with Rail Configurations
				CHECKED			
				ENG APPR.			
				MFG APPR.			
		INTERPRET GEOMETRIC TOLERANCING PER:		Q.A.			SIZE DWG. NO. REV <b>B</b> <b>0</b>
		MATERIAL		COMMENTS: 63 RA surface finish			
NEXT ASSY	USED ON	FINISH					
APPLICATION		DO NOT SCALE DRAWING				SCALE: 1:3	WEIGHT:
						SHEET 1 OF 6	

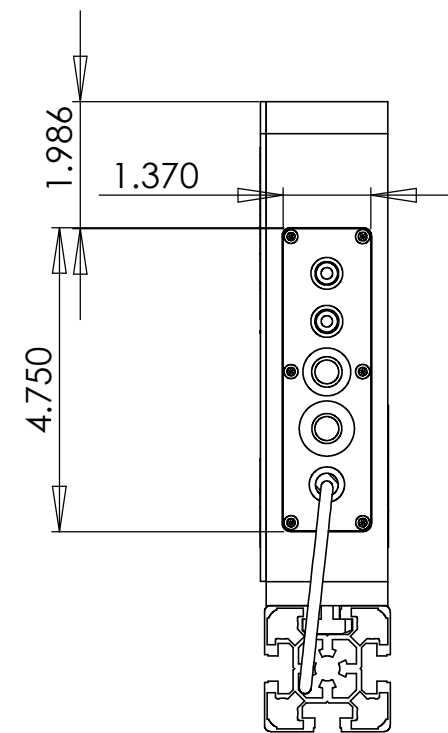
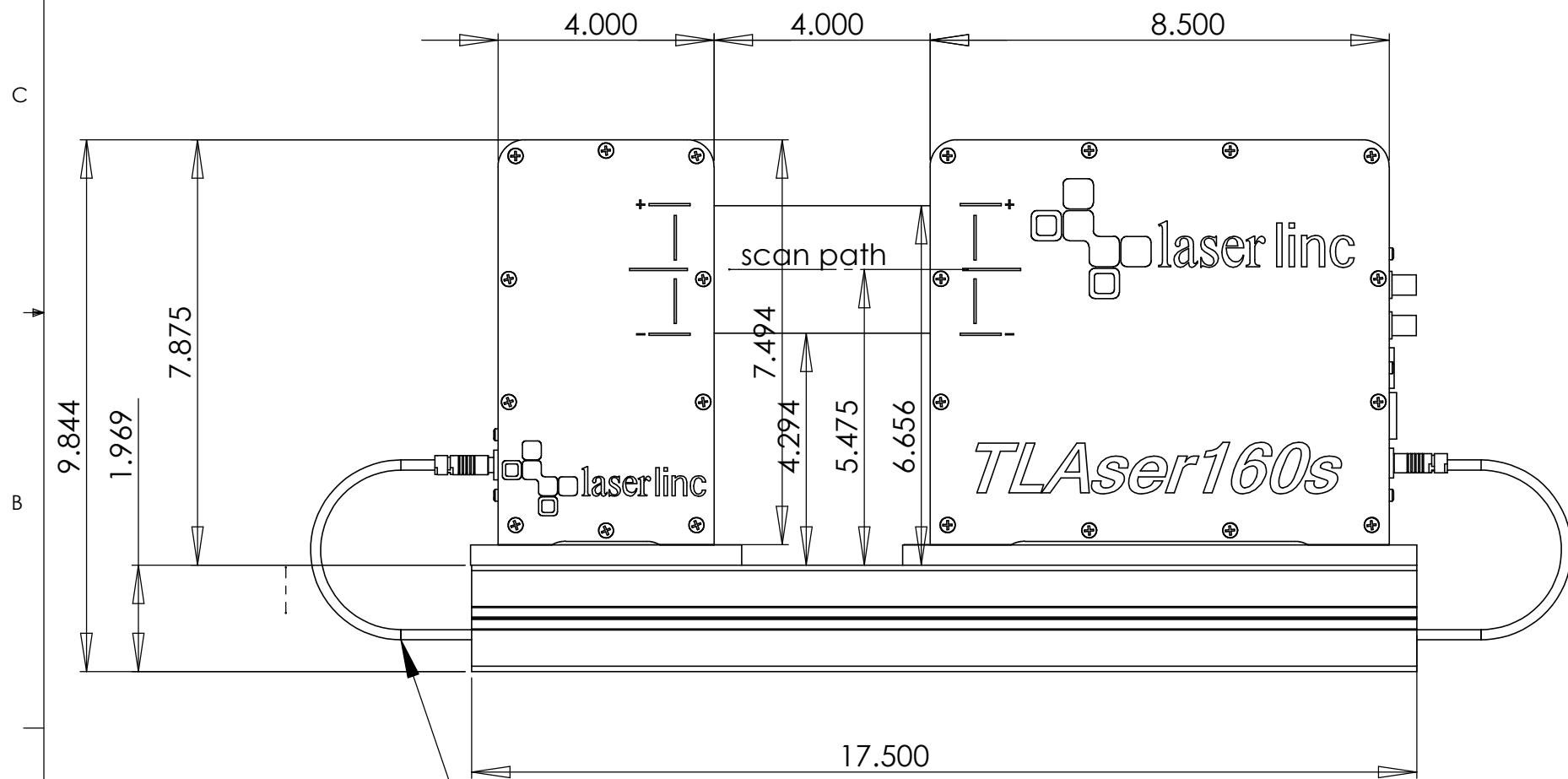
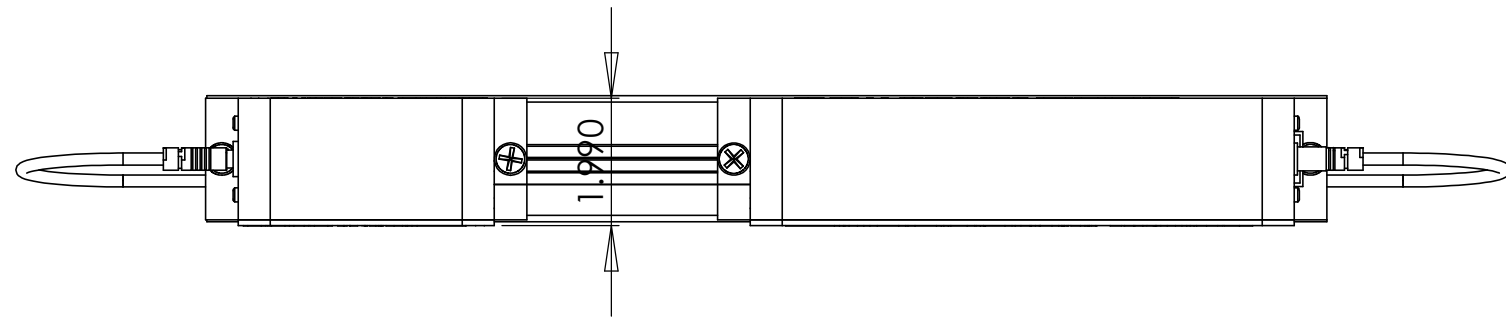

Wire Length=33"

**PROPRIETARY AND CONFIDENTIAL**  
 THE INFORMATION CONTAINED IN THIS DRAWING IS THE SOLE PROPERTY OF LASERLINC, INC. ANY REPRODUCTION IN PART OR AS A WHOLE WITHOUT THE WRITTEN PERMISSION OF LASERLINC, INC IS PROHIBITED.

		UNLESS OTHERWISE SPECIFIED:		NAME	DATE	LaserLinc, Inc.	
		DIMENSIONS ARE IN INCHES		DRAWN	ASM	10/24/06	TITLE: 160 Assembly with Rail Configurations
		TOLERANCES:		CHECKED			
		FRACTIONAL ±		ENG APPR.			
		ANGULAR: MACH ± BEND ±		MFG APPR.			
		TWO PLACE DECIMAL ±0.010		Q.A.			SIZE DWG. NO. REV <b>B</b> 0160-0001-00-04 <b>0</b>
		THREE PLACE DECIMAL ±0.005		COMMENTS:	63 RA surface finish		
		INTERPRET GEOMETRIC TOLERANCING PER:				SCALE: 1:3 WEIGHT: SHEET 2 OF 6	
		MATERIAL					
		FINISH					
NEXT ASSY	USED ON						
APPLICATION		DO NOT SCALE DRAWING					

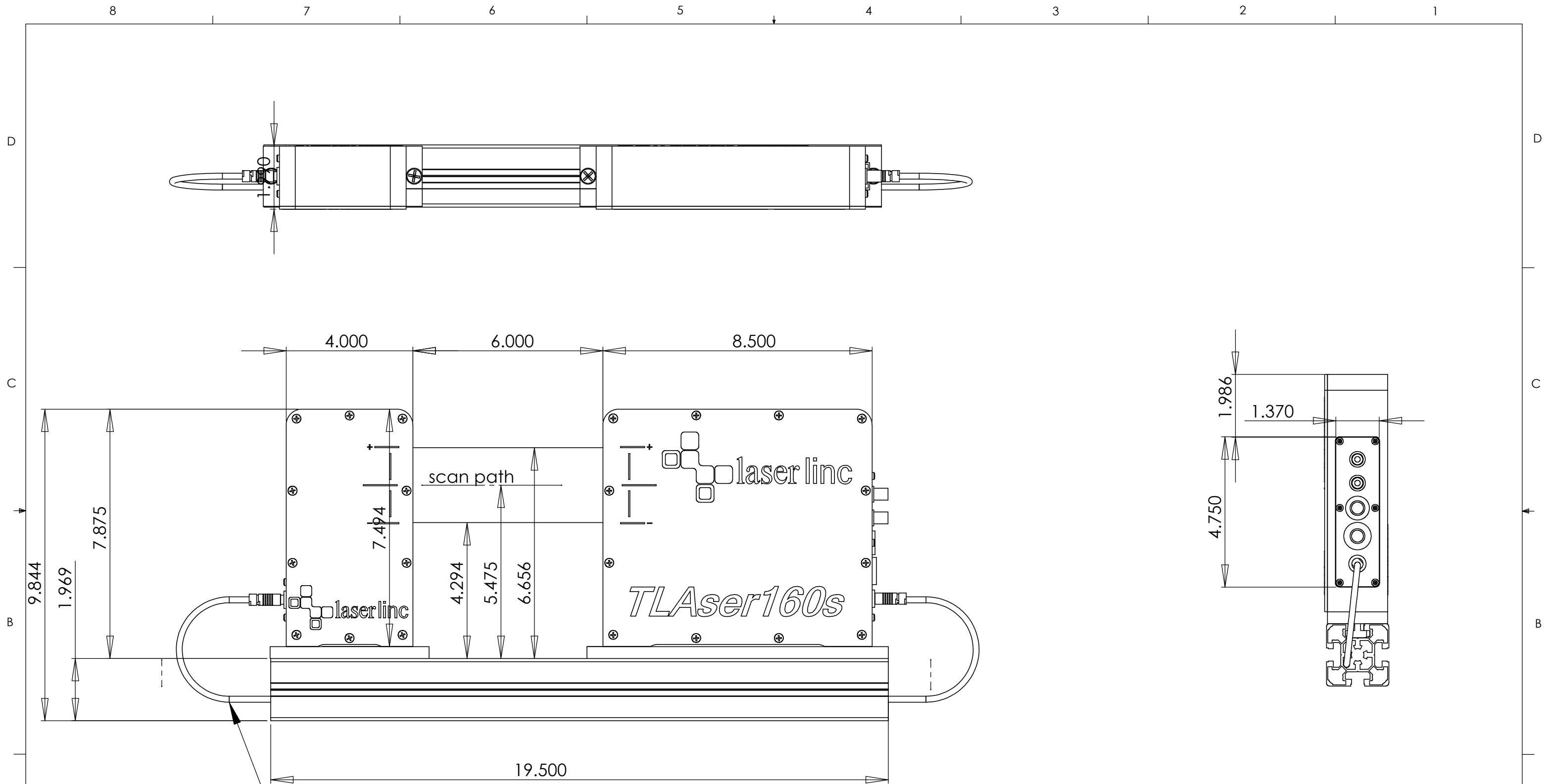

Wire Length=35"

**PROPRIETARY AND CONFIDENTIAL**  
 THE INFORMATION CONTAINED IN THIS DRAWING IS THE SOLE PROPERTY OF LASERLINC, INC. ANY REPRODUCTION IN PART OR AS A WHOLE WITHOUT THE WRITTEN PERMISSION OF LASERLINC, INC IS PROHIBITED.

		UNLESS OTHERWISE SPECIFIED:				NAME		DATE		LaserLinc, Inc.	
		DIMENSIONS ARE IN INCHES		DRAWN		ASM		10/24/06		TITLE:	
		TOLERANCES:		CHECKED						160 Assembly with Rail Configurations	
		FRACTIONAL ±		ENG APPR.						REV	
		ANGULAR: MACH ± BEND ±		MFG APPR.						0	
		TWO PLACE DECIMAL ±0.010		Q.A.						SIZE	
		THREE PLACE DECIMAL ±0.005		COMMENTS:		63 RA surface finish		DWG. NO.		0160-0001-00-06	
		INTERPRET GEOMETRIC TOLERANCING PER:						WEIGHT:		SHEET 3 OF 6	
		MATERIAL									
NEXT ASSY		USED ON		FINISH							
APPLICATION				DO NOT SCALE DRAWING							

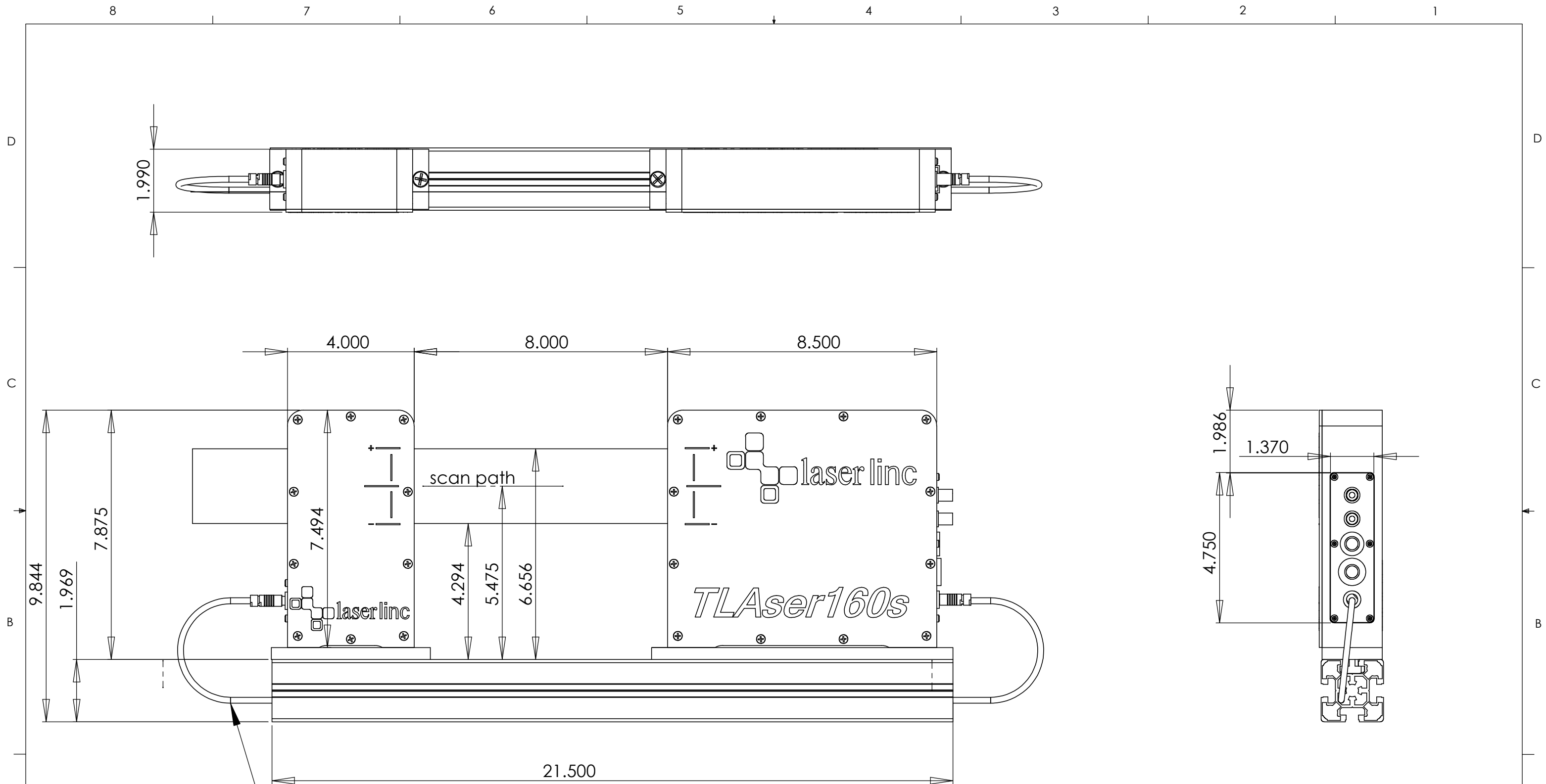

Wire Length=37"

**PROPRIETARY AND CONFIDENTIAL**  
 THE INFORMATION CONTAINED IN THIS DRAWING IS THE SOLE PROPERTY OF LASERLINC, INC. ANY REPRODUCTION IN PART OR AS A WHOLE WITHOUT THE WRITTEN PERMISSION OF LASERLINC, INC IS PROHIBITED.

		UNLESS OTHERWISE SPECIFIED:		NAME		DATE		LaserLinc, Inc.	
		DIMENSIONS ARE IN INCHES		DRAWN		ASM		10/24/06	
		TOLERANCES:		CHECKED				TITLE:	
		FRACTIONAL ±		ENG APPR.				160 Assembly with Rail Configurations	
		ANGULAR: MACH ± BEND ±		MFG APPR.				SIZE	
		TWO PLACE DECIMAL ±0.010		Q.A.				DWG. NO.	
		THREE PLACE DECIMAL ±0.005		COMMENTS:		63 RA surface finish		REV	
		INTERPRET GEOMETRIC TOLERANCING PER:						0	
		MATERIAL						SCALE: 1:3	
NEXT ASSY		USED ON						WEIGHT:	
								SHEET 4 OF 6	
APPLICATION		DO NOT SCALE DRAWING							



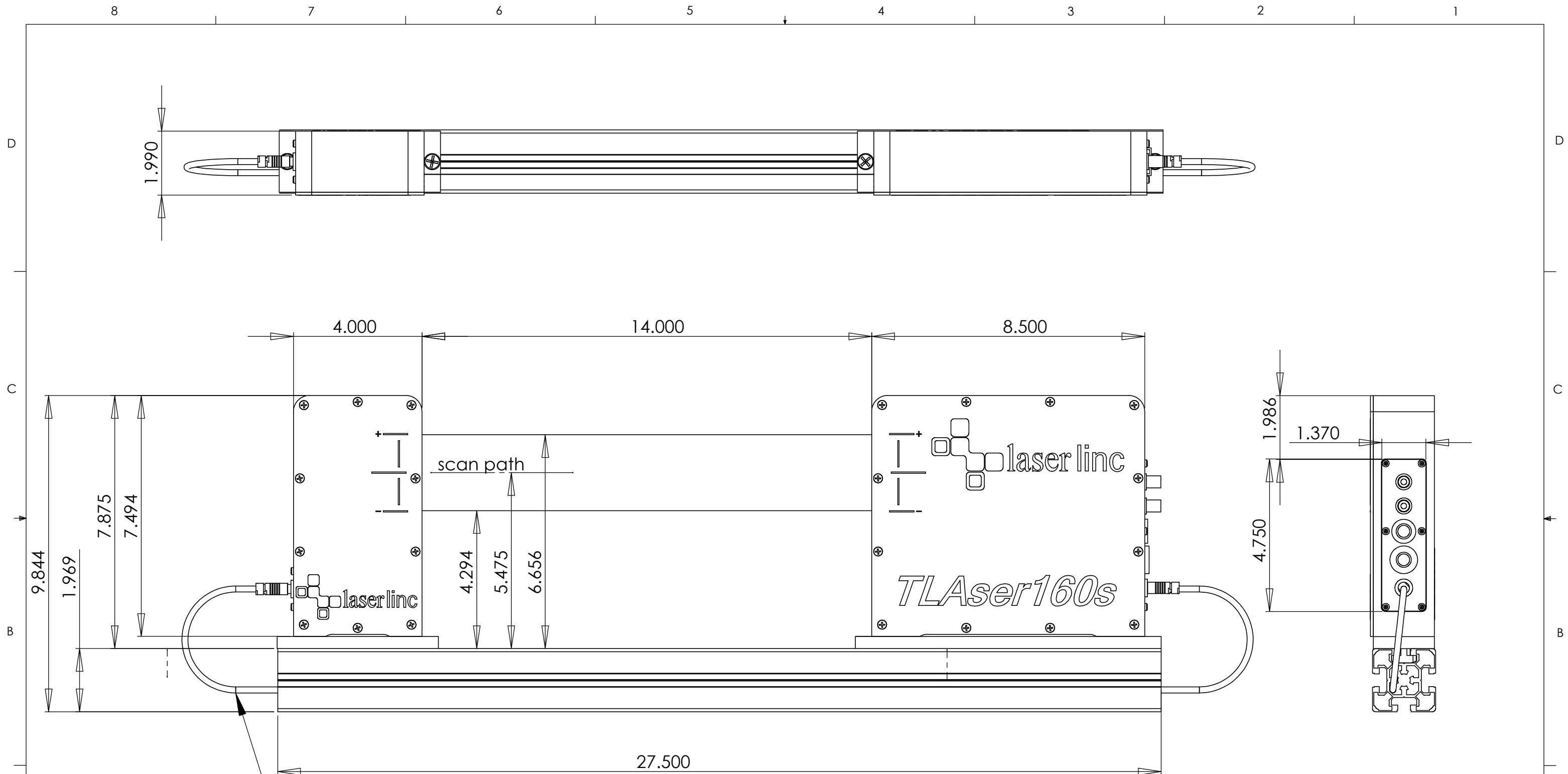

Wire Length=43"

**PROPRIETARY AND CONFIDENTIAL**  
 THE INFORMATION CONTAINED IN THIS DRAWING IS THE SOLE PROPERTY OF LASERLINC, INC. ANY REPRODUCTION IN PART OR AS A WHOLE WITHOUT THE WRITTEN PERMISSION OF LASERLINC, INC IS PROHIBITED.

		UNLESS OTHERWISE SPECIFIED:		NAME	DATE	LaserLinc, Inc.	
		DIMENSIONS ARE IN INCHES		DRAWN	ASM	10/24/06	TITLE: 160 Assembly with Rail Configurations
		TOLERANCES:		CHECKED			
		FRACTIONAL ±		ENG APPR.			
		ANGULAR: MACH ± BEND ±		MFG APPR.			
		TWO PLACE DECIMAL ±0.010		Q.A.			SIZE DWG. NO. REV <b>B</b> 0160-0001-00-14 <b>0</b>
		THREE PLACE DECIMAL ±0.005		COMMENTS: 63 RA surface finish			
		INTERPRET GEOMETRIC TOLERANCING PER:					SCALE: 1:3 WEIGHT: SHEET 6 OF 6
		MATERIAL					
		FINISH					
NEXT ASSY	USED ON	APPLICATION		DO NOT SCALE DRAWING			